

NTC Standard and Custom Probes

Surface Probes

Designed for temperature measurement of any flat surface, surface probes are offered in any standard resistance/curve combination in our QTMC product line, in either point matched or interchangeable tolerances (see page 12).

Quality Thermistor specializes in custom probe design and development. The package styles shown here are considered "standard" but many other packages are available. Contact Quality Thermistor for all of your probe design needs including:

- Connectors/Terminals
- High Temperature and Hi-Voltage Wire or Cable
- High-Dielectric Strength Designs
- Custom Molded Packages

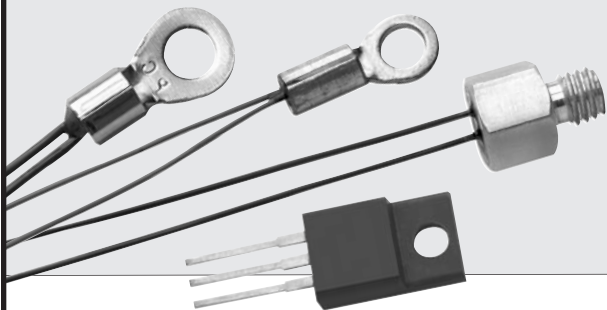

QTRL1

Ring tongue lug probes. Excellent for control and measurement of any flat surface. Standard lead length 1.5". Parts available in standard QTMC configurations.

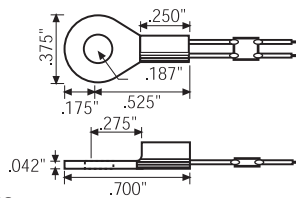

QTRL2

Ring tongue lug probes. Excellent for control and measurement of any flat surface. Standard lead length 1.5". Parts available in standard QTMC configurations.

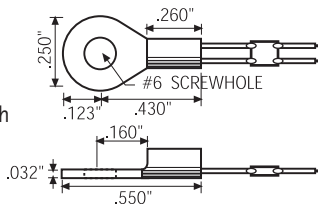

QTF

Aluminum heat sink sensor. Great for applications where shock and vibration are present. Parts available in standard QTMC configurations.

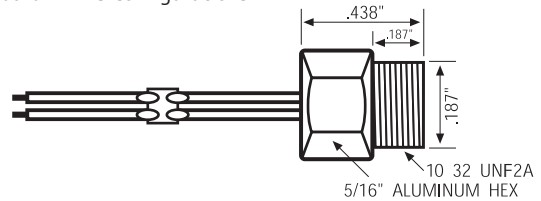

QT0220F NTC THERMISTOR

Heat sink temperature measurement has always posed a challenge for engineers in areas such as power supply manufacturing. The

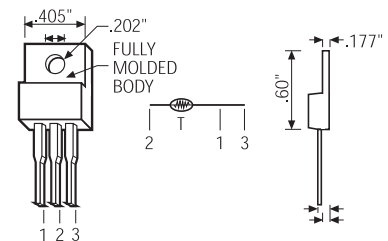

QT0220F thermistor was designed for use in such applications. Based on the standard TO220 package, this device is ideal for use in hostile environments.

PART NUMBER	RESISTANCE @ 25°C	R/T CURVE
QT0220FZ-103	10,000Ω	Z
QT0220FM-303	30,000Ω	M
QT0220FM-503	50,000Ω	M
QT0220FV-104	100,000Ω	V

Ordering Information

QTRL1 Z-10 3 J-6

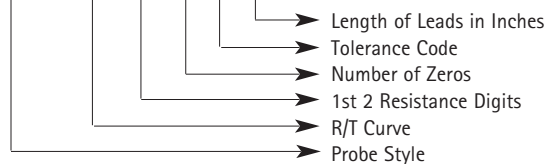

Tolerance Options:

- K = 10%
- J = 5%
- G = 2%
- F = 1%

Standard Lead Options:

Parts come standard with #28 AWG black Kynar insulated leads in either 6", 12", or 24" lengths.

Note: See data sheets for R/T curves.